

Powered **by air**

**WALL-MAN<sup>®</sup>**  
**LIFTMAN<sup>™</sup>**

**PNEUMATIC  
ACCESS  
PLATFORMS**

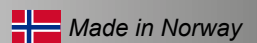

# WHY PLATFORMS FROM REGLO?

Reglo's close cooperation with customers and partners through more than 30 years, and installations in over 40 countries worldwide, has accumulated a great understanding of

how our solutions can best support our customer's business models and day-to-day operation in a productive and efficient manner.

With the WALL-MAN® and LIFTMAN™ you will experience an increase in business profitability through:

- Increased productivity – more work is conducted in less time.
- Increased quality in the finished work – optimal working position/access and performance throughout the job.
- Better working environment for the operators – the safety of the workers is optimized with reduction of dangerous working positions (ladders/scaffoldings), less tiring positions.
- Low operational costs – low maintenance cost throughout the product's life time.
- Long lasting and durable products – with a long lifetime the need for future investments is reduced, and the return on the investment increased.
- Easy to use – intuitive control panels and mechanisms.



WALL-MAN®

LIFTMAN™

Reglo will continue to be dedicated to innovation based upon our customer's requirements and feedbacks. Reglo's product design and development shall always reflect quality and durability for our customers.

According to the EU Directive 2001/45 and HSE recommendations (Health and Safety Executive), working at heights requires

appropriate equipment. The WALL-MAN® and LIFTMAN™ will comply to the directives and recommendations.

Reglo puts great efforts in being compliant to all the latest standards, and all the lifts are certified:



Powered *by air*

## WHERE & HOW?

WALL-MAN® and LIFTMAN™ are durable and reliable access platform systems, which require very little maintenance. They are designed to be used in a flammable environment (ATEX).

A typical environment would be a spray booth, where the advantages of the WALL-MAN® can be fully utilized. WALL-MAN® would be mounted onto rails on the side-walls, granting access to the whole length of the booth. The WALL-MAN® would allow the operator to move up/down, left/right and in/out in an effective way, as the work on the object is being done. An optimal working position is given to the operator, resulting in a faster and better finishing and reduced strain on the body/back.

More work can be done in a shorter time and more effective way (cost savings), while

increasing the safety for the workers and reducing the strain inflicted to the workers using for instance ladders and scaffolds.

Users have reported lower levels of absence of workers, improved productivity and reduced overspray, after installations of WALL-MAN® and LIFTMAN™.

The LIFTMAN™ would be the ideal tool and equipment in a preparation booth, where tasks such as sanding, masking, smaller repair jobs and sign- and decoration application are being done.

Both the WALL-MAN® and LIFTMAN™ are easy to operate. WALL-MAN® and LIFTMAN™ will improve the productivity and reduce time consumed on a job/project, as well as reduce both direct and indirect costs.

## YOUR BENEFITS WITH WALL-MAN® AND LIFTMAN™

- Increased productivity
- Increased quality in the finished work
- Safer and better working environment for the operators
- Lower production costs as a result of direct and indirect cost savings
- Low operational costs when in use
- Quality - long lasting and durable systems, reducing the need of investments for years to come
- Compliant to norms and standards through certification: CE, UL, ATEX



Powered **by air**

**WALL-MAN®**

- No contact with the floor
- Three dimensional movement
- Non slip floor in cage
- Made to order
- ATEX approved



Powered  
by air

# WALL-MAN® Features & Specifications

<b>Design:</b>	Mounted on the wall – no contact with floor, ergonomic operation	
<b>Construction:</b>	Welded steel	
<b>Finish:</b>	RAL 5015	
<b>Net weight:</b>	320 kg	
<b>Energy:</b>	Entirely pneumatically operated	
<b>Functions:</b>	Three dimensional movement; up/down, in/out, left/right	
<b>Characteristics:</b>	Easy to install, minimum of maintenance.	
<b>Models:</b>	From 500 to 1300 mm telescopic extension and 2D and 3D versions – lifting height (floor of cage) up to 4,5 m	
<b>Payload:</b>	150 kg (one person + equipment)	
<b>Controls:</b>	Inside cage: Up/down, in/out, left/right At ground level: Up/down	
<b>Brakes:</b>	Brake system in rail for steady positioning. <i>Optional: brakes on lower support wheels.</i>	
<b>Air supply:</b>	Min. 6 bar, min. 350 ltr/minute supplied via hoses on self-retracting reels or via energy chain. A compressed air outlet for air tools is provided in the cage.	
<b>Imposed loads:</b>	<i>Upper rail:</i>	Vertical load approx. 420 kg Horizontal load approx. 120 kg
	<i>Lower support wheels:</i>	Vertical load 0 kg Horizontal load approx. 120 kg (Model 1000 – std. lifting height)
<b>Approvals:</b>	CE, UL and ATEX certified.	

## Safety features:

### Up/down:

- Safety flow restrictors in case of air loss
- Safety factor 11 on lifting chains
- Safety chain on air supply
- Chain slack protection

### In/out:

- Pressurized cylinders for steady positioning
- Loss of air pressure allows manual movement

### Sideways:

- Brake system for steady parking
- Guide rollers to centre the travel in top rail
- Rubber stoppers in rail
- Loss of air pressure allows manual movement

### Miscellaneous:

- Non-slip floor in cage
- Signal horn
- Chain protection panels
- Hook in cage for safety harness
- Self-closing hinges
- Self-closing latches
- Emergency lowering



**Accessories & modifications:**  
See page 8 for options.

# WALL-MAN® XL

- 250 kg lifting capacity/payload
- 2 m cage width - room for two persons
- Maximum lifting height 6 m
- Three dimensional movement
- Non slip floor in cage
- Made to order
- ATEX approved

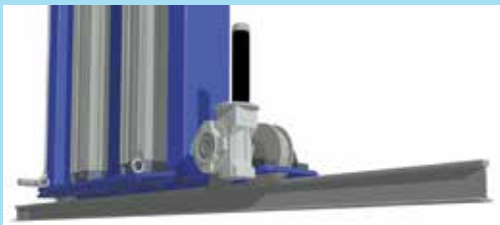

by air

Powered

# WALL-MAN® XL Features & Specifications

<b>Design:</b>	Running on rails on the floor – ergonomic operation	
<b>Construction:</b>	Welded steel	
<b>Finish:</b>	RAL 5015	
<b>Net weight:</b>	790 kg	
<b>Energy:</b>	Entirely pneumatically operated	
<b>Functions:</b>	Three dimensional movement; up/down, in/out, left/right	
<b>Characteristics:</b>	Easy to install, minimum of maintenance.	
<b>Models:</b>	From 1000 to 1300 mm telescopic extension – lifting height (floor of cage) up to 6 m	
<b>Payload:</b>	250 kg (two persons + equipment)	
<b>Controls:</b>	Inside cage: Up/down, in/out, left/right At ground level: Up/down	
<b>Brakes:</b>	Brakes on lower support wheels.	
<b>Air supply:</b>	Min. 6 bar, min. 350 ltr/minute supplied via hoses on self-retracting reels or via energy chain. A compressed air outlet for air tools is provided in the cage.	
<b>Imposed loads:</b>	<i>Upper rail:</i>	Vertical load approx. 0 kg Horizontal load approx. 163 kg
	<i>Lower support wheels:</i>	Vertical load 1040 kg Horizontal load approx. 163 kg (Model XL 1000 – std. lifting height)
<b>Approvals:</b>	CE, UL and ATEX certified.	



## Safety features:

### Up/down:

- Safety flow restrictors in case of air loss
- Safety factor 11 on lifting chains
- Safety chain on air supply
- Chain slack protection

### In/out:

- Pressurized cylinders for steady positioning
- Loss of air pressure allows manual movement

### Sideways:

- Brake system for steady positioning
- Hook on lower support wheels to keep wheels in the rail
- Rubber stoppers in rail
- Loss of air pressure allows manual movement

### Miscellaneous:

- Non-slip floor in cage
- Signal horn
- Chain protection panels
- Hook in cage for safety harness
- Self-closing hinges
- Self-closing latches
- Emergency lowering

## Accessories & modifications:

See page 8 for options.

WALL-MAN® / WALL-MAN® XL



1 Foot pedal – as supplement to the three joysticks.



2 Breathing air in cage.



3 Automatic stop when telescoping out.



4 Tool tray on back wall of cage.

WALL-MAN®

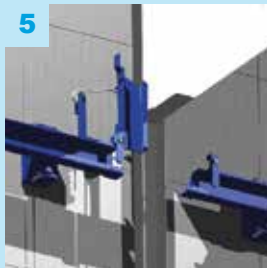

5 Rail pivot to pass dividing door. Various solutions.



6 Access step to cage when needed.



7 Brakes on lower support wheels.

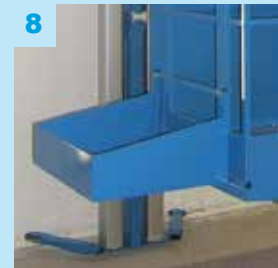

8 Shelf 600x625 mm for paint pots/cans/boxes.



9 Chain drive – when upper rail is slippery.

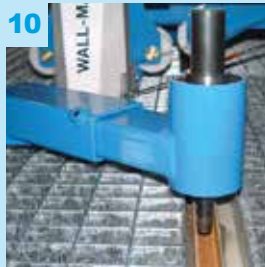

10 Floor guidance of lower support wheels.



11 Collision protection on top of mast when more than one WALL-MAN® on same rail.



12 In/out movement operated from floor.

## In addition the following features can be delivered:

WALL-MAN® / WALL-MAN® XL

- Extra door in front of cage.
- Protection cover under cage.
- Various brackets for tools in cage.
- Various brackets for hose reels.
- Multi wheel slide - for extra stability.
- Extra air connection in cage.
- Other extras as per agreement.

WALL-MAN®

- Increased width of cage – up to 1200 mm.
- High torque air motor – for special requirements like long distances etc.
- Extra emergency lowering on opposite side from standard.
- Doorstopper – to avoid collision when personnel door is opened.
- Multi wheel lower support, when passing more than one personnel door.
- Wider distance lower support wheels – for extra wide personnel doors.
- Protection of lower support wheels.
- Trailer for paint pot/can/box.

# CHECKLIST FOR QUOTATION

For quotations please submit the following information

**Objects:** *L x W x H:* max. \_\_\_\_\_ x max. \_\_\_\_\_ x max. \_\_\_\_\_ m  
*Object on rails:*  no  yes

**Spray booth:** *L x W x H:* \_\_\_\_\_ x \_\_\_\_\_ x \_\_\_\_\_ m  
*Lights 45°*  no  yes H= \_\_\_\_\_ mm (from floor)  
*Personnel doors*  no  yes W= \_\_\_\_\_ mm  
*Obstacles on wall*  no  yes D= \_\_\_\_\_ mm (air outlets, switches, lights,...)

*Dividing doors do not apply to WALL-MAN® XL*

*Dividing doors*  no  yes L= \_\_\_\_\_ + \_\_\_\_\_ mm

If dividing doors, pick design below:

*Door integrated in wall:*



*Door rail on wall, cut allowed:*



*Door rail on wall, cut NOT allowed:*

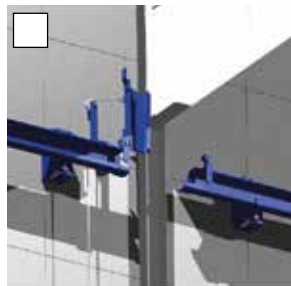

*Door rail with offset and cut:*

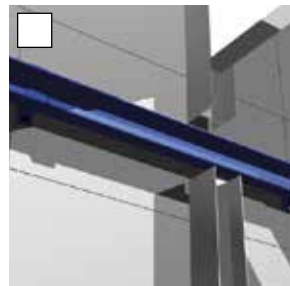

Other requirements, comments, additional information

---

---

**Company name:** \_\_\_\_\_

**Contact person:** \_\_\_\_\_

**Address:** \_\_\_\_\_

**Tel.:** \_\_\_\_\_

**E-mail:** \_\_\_\_\_

**Project/end user:** \_\_\_\_\_

**Quotation validity:** \_\_\_\_\_

*(estimated date)*

Mail to: [info@reglo.no](mailto:info@reglo.no)



# WALL-MAN® RANGE

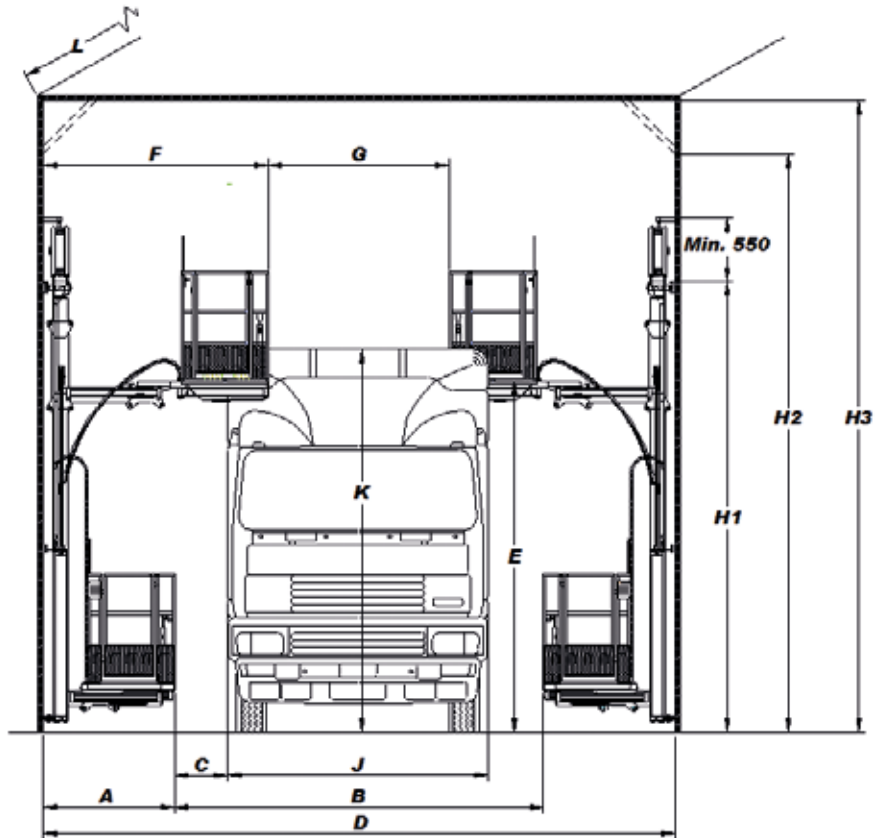

WALL-MAN®		Distance from wall <sup>1)</sup>		Cage size <sup>2)</sup>		Lifting Height <sup>4)</sup>	
Standard models	Axis	Min (A)	Max (F)	Width	Depth	Std.	Max
500 <sup>3)</sup>	3D	885	1385	900	570	3275	4525
600	3D	935	1535	900	620	3275	4525
700	3D	985	1685	900	670	3275	4525
800	3D	1035	1835	900	720	3275	4525
900	3D	1085	1985	900	770	3275	4525
<b>1000</b>	<b>3D</b>	<b>1135</b>	<b>2135</b>	<b>900</b>	<b>820</b>	<b>3275</b>	<b>4525</b>
1100	3D	1185	2285	900	820	3275	4525
1200	3D	1235	2435	900	820	3275	4525
1300	3D	1285	2585	900	820	3275	4525

Measurements in mm.

- 1) Offset possible up to 250 mm - longer reach possible with brackets.
- 2) Cage width can be extended up to 1200 mm.
- 3) One door only.
- 4) Distance between booth floor and cage floor.

All models are available in 2D versions as well.

# WALL-MAN® XL RANGE

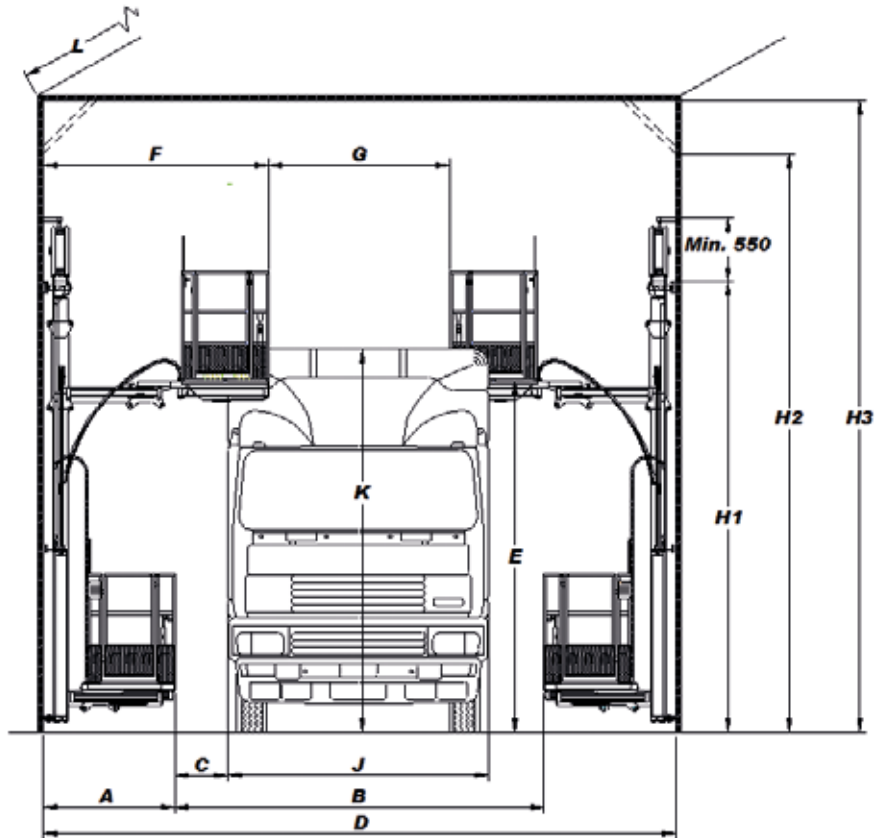

WALL-MAN® XL		Distance from wall <sup>1)</sup>		Cage size <sup>2)</sup>		Lifting Height <sup>3)</sup>	
Standard models	Axis	Min (A)	Max (F)	Width	Depth	Std.	Min
1000	3D	1240	2240	2005	820	6000	4000
1300	3D	1390	2690	2005	820	6000	4000

Measurements in mm.

- 1) Offset possible up to 250 mm - longer reach possible with brackets.
- 2) Other sizes on request.
- 3) Distance between booth floor and cage floor.



Powered  
by air

**LIFTMAN™**

**by air**

**Powered**



**FEATURES:**

- Entirely pneumatically operated
- Occupies a minimum of floor space
- Sharp turning circle for easy access
- Controls and air outlet inside the cage
- Twin wheels as option
- Delivered ready-to-use
- ATEX approved

# LIFTMAN™ Features & Specifications

<b>Design:</b>	Fully mobile
<b>Construction:</b>	Welded steel
<b>Finish:</b>	RAL 3002
<b>Net weight:</b>	400 kg
<b>Energy:</b>	Entirely pneumatically operated
<b>Payload:</b>	140 kg (1 person + equipment)
<b>Lifting height:</b>	Floor height 2730 mm
<b>Working range:</b>	Up to 10 m radius from air connection point
<b>Controls:</b>	<i>Lifting:</i> Hand lever valve in cage <i>Driving:</i> Foot pedal on cage floor <i>Steering:</i> Hand lever valve in cage
<b>Air supply:</b>	6-8 bar, min. 350 l/minute supplied via a 10 m air hose on a self-retracting reel in the base. A compressed air outlet for air tools is provided in the cage.
<b>Approvals:</b>	CE, UL and ATEX certified



## Safety features:

### Up/down:

- Safety flow restrictors in case of air loss
- Chain slack protection

### Miscellaneous:

- Nonslip floor in cage
- Signal horn
- Chain protection panels
- Hook in cage for safety harness
- Self-closing hinges
- Self-closing latches
- Emergency lowering



# LIFTMAN™ FOLD

by air

Powered

## FEATURES:

- **Manual steering and movement – pneumatically operated up/down function**
- **Folding function of mast enables passage through lower doors etc.**
- **Entirely pneumatically operated**
- **Occupies a minimum of floor space**
- **Sharp turning circle for easy access**
- **Controls and air outlet inside the cage**
- **Outriggers are standard**
- **Twin wheels as option**
- **Delivered ready-to-use**
- **ATEX approved**
- **Outdoor and indoor use**



# LIFTMAN™ FOLD Features & Specifications

<b>Design:</b>	Fully mobile with fold down function
<b>Construction:</b>	Welded steel
<b>Finish:</b>	RAL 1023
<b>Net weight:</b>	470 kg
<b>Energy:</b>	Entirely pneumatically operated
<b>Payload:</b>	140 kg (1 person + equipment)
<b>Lifting height:</b>	Floor height, unfolded; 3140 mm Floor height, folded; 2050 mm
<b>Controls:</b>	<i>Lifting:</i> Hand lever valve in cage <i>Steering/Driving:</i> Manual
<b>Air supply:</b>	6-8 bar, min. 350 l/minute. A compressed air outlet for air tools is provided in the cage.
<b>Approvals:</b>	CE, UL and ATEX certified

*An optional compressed air container (300 bar) can be used in locations where compressed air is not available (approximately 15 up and down operations).*



## Safety features:

### Up/down:

- Safety flow restrictors in case of air loss
- Safety chain on air supply
- Chain slack protection

### Miscellaneous:

- Nonslip floor in cage
- Signal horn
- Hook in cage for safety harness
- Self-closing hinges
- Self-closing latches
- Emergency lowering



*The folding function enables Liftman Fold to pass through doors and passage ways with as low as 2050 mm height.*

# SEGMENTS & ADAPTABILITY

## COMMERCIAL VEHICLES



Commercial heavy utility vehicles have traditionally been the most important area of use for the WALL-MAN® and LIFTMAN™ access platforms. Manufacturers, body builders and repair and maintenance shops all over the world have found WALL-MAN® to be the optimal work platform in their spray booths/paint shops.

Painting of very expensive aircraft components requires extremely high accuracy of workmanship. This places great demands on personnel access platforms in terms of manoeuvrability. The WALL-MAN® provides the required accuracy in that the operator has full control of left/right, up/down and in/out movements using the ergonomically correctly placed joysticks.



## AIRCRAFT

## PAINT BOOTHS



After over 30 years on the market, the WALL-MAN® has been approved by most manufacturers of paint booths worldwide. The WALL-MAN® is widely recognised for its reliability and long service life, and can be installed in the majority of paint booths.

WALL-MAN® and LIFTMAN™ access platforms are used by an increasing variety of businesses. From the biggest wind turbine blades to the smallest parts hanging on the conveyor – from conventional coating of large surfaces to powder-coating of open steel structures – WALL-MAN® and LIFTMAN™ platforms can be adapted for most situations in which paint is applied.



## INDUSTRIAL

Powered *by air*

WALL-MAN® is an engineered product with great adaptability, being used in many applications. Made to order, the wide model range and numerous accessories and modifications make WALL-MAN® the best choice for any painter.



### RAIL

There is an increasing number of WALL-MAN®s sold to manufacturers of rolling stock (trains, trams and light rail vehicles). More and more users are discovering the advantages of fast and flexible three dimensional movement; left/right, up/down and in/out. WALL-MAN® can be modified to meet special requirements, for example extra door in the front.

WALL-MAN® and LIFTMAN™ access platforms were initially designed for buses and lorries. Small maintenance shops as well as large international manufacturers of buses and coaches have put the excellent properties of the Reglo platforms to use. Adaptation to each individual cabin and ideal distance to the objects are features that ensure economy and a perfect finish.



### BUS & COACH



### MILITARY

From Korea via the Falklands to the UK the WALL-MAN® is valued by the defence sector due to its reliability and modest maintenance requirements. In addition to paint application, the defence sector uses the WALL-MAN® for several other tasks.

We are always discovering new applications for the WALL-MAN® concept. Examples are powder painting of large objects and waterjet cleaning of large pieces of machinery.



### OTHER USES



by air  
Powered

## A SELECTION OF OUR REFERENCES



**WALL-MAN<sup>®</sup> & LIFTMAN<sup>™</sup>**

Installed in over 40 countries worldwide

## WHO WE ARE

Reglo AS is located in Andebu, Norway. Reglo AS manufactures the pneumatically operated access platforms WALL-MAN® and LIFTMAN™ for world-wide distribution.

WALL-MAN® and LIFTMAN™ have been present in the market for more than 30 years, making WALL-MAN® and LIFTMAN™ a recognized and valued system for both partners, distributors and end customers.

WALL-MAN® and LIFTMAN™ systems have been exported to over 40 countries, and entered various segments ranging from traditional commercial vehicles to military, aerospace, rail and engineering.

Reglo AS will continue to improve the products in accordance with norms and standards, needs and requirements from the market and the users, in order to still be the preferred partner in the market.



*Located near the regional airport Sandefjord Torp and working with a large network of qualified distributors worldwide, Reglo is always close to the customers.*



**Reglo AS,**

Halumveien 11

NO-3158 ANDEBU, Norway

info@reglo.no | Tel. +47 33 43 02 80

Visit and follow Reglo AS on:

[www.reglo.no](http://www.reglo.no)

